



**WildKat Rotary**

# Side Shift

INDUSTRIAL  
MOWER

Ready, willing and able. The Tiger WildKat is built strong to stand up to your toughest mowing needs.

The unique arch boom design with swing system, optional rotary or flail cutter heads and combined side shift of over 40" gives the operator of this mower the capability to handle almost any mowing problem that can come their way.

If you want to add additional features look at the optional rear hydraulic side shifting flail mower, with the ability to mow directly behind the tractor or shift to the right up to 31". This combination gives you versatility that no other mowing system can offer.

Rear hydraulic flail is available in 90" and 96" Hydraulic driven - Hydraulic side shift, or PTO driven- Hydraulic side shift.

WildKat available in 75" Flail and 60" Rotary.



**WildKat Flail with Rear Side Shift Flail**

DURABILITY

INNOVATION

COMMITMENT





**WildKat Flail**

- Arch design with Rear Stow system
- Hydraulic breakaway
- 41 inches of combined Side Shift capability.
- 30 inches of Hydraulic Side Shift
- 11 inches of Mechanical Side Shift



**75" FLAIL**



**60" ROTARY**



**HYDRAULICALLY DRIVEN  
REAR SIDE SHIFT FLAIL  
HYDRAULICALLY SHIFTS RIGHT 31"  
ELIMINATES PTO SHAFT AND  
INCREASES SIDE SHIFT**

**Available in Super Duty Only**

**PTO DRIVEN  
REAR SIDE SHIFT FLAIL  
HYDRAULICALLY SHIFTS RIGHT 23"**

**Less cost with No hydraulic lines.**

**Available in Super Duty and  
Extreme Duty**





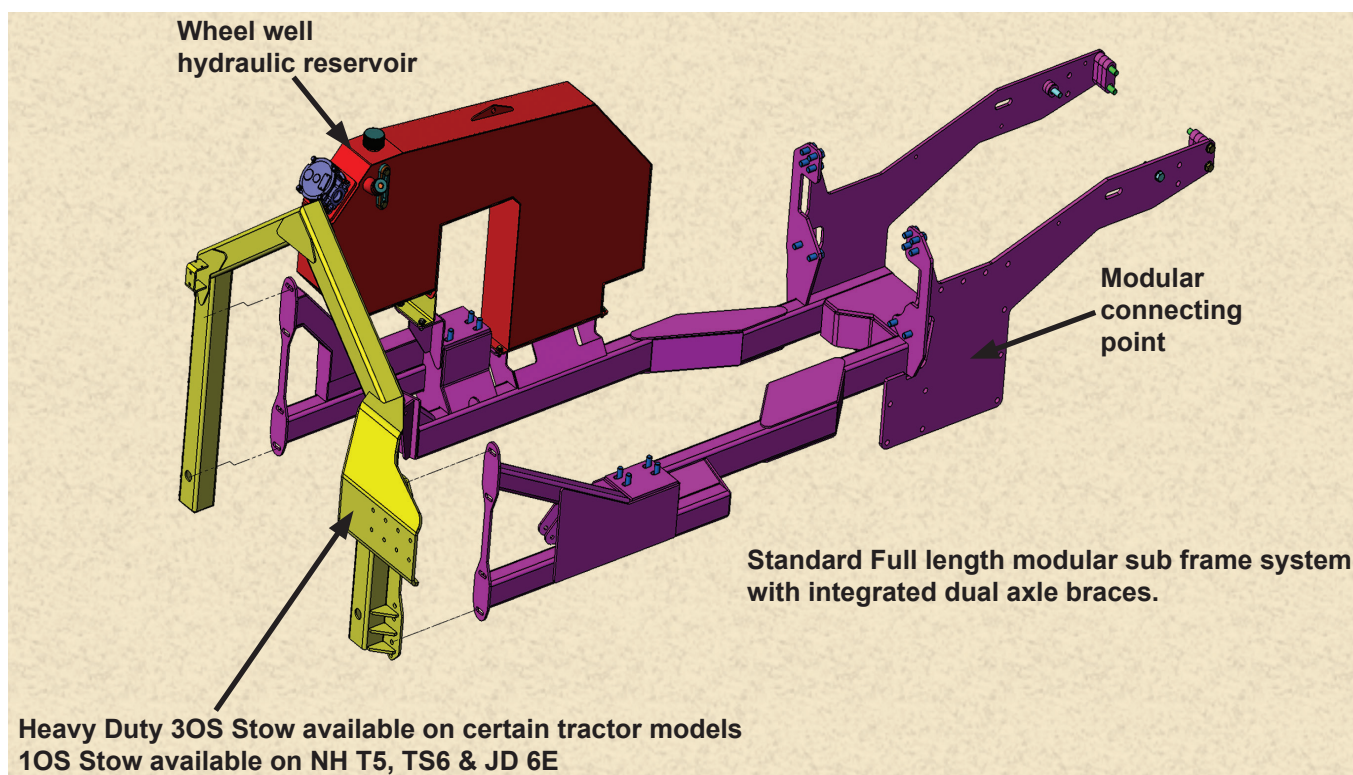

To enhance the adaptability of our products, Tiger offers a modular mounting frame to ease mower change for your vegetation needs. This unique design offers interchangeability from the Wildkat to any Tiger side mower system. (tractor remotes would be used for side mower)

With the Tiger modular frame, changing mower types can be accomplished in approximately 8 hours.

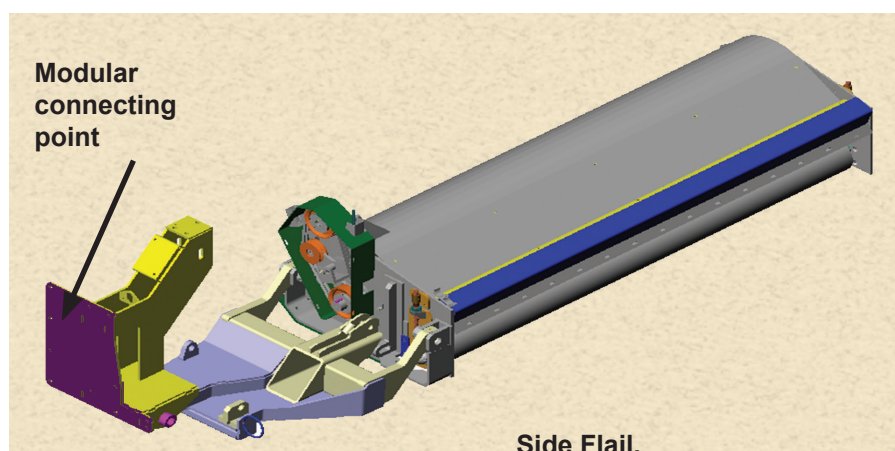
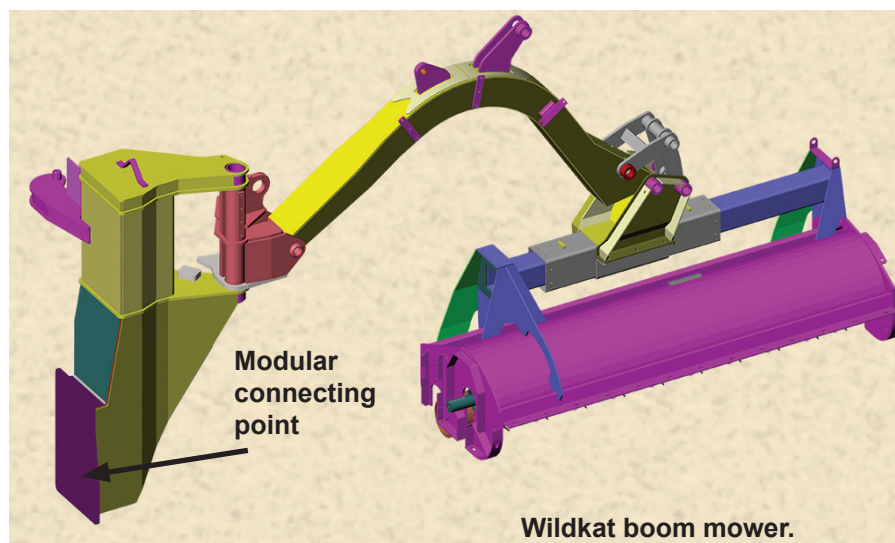



# Hydraulic Controls

## Joystick with EFS - Easy Float System

- CAN-bus Joystick- electronic over hydraulic control system.
- Dual Float system on Boom and Deck Roll functions, and includes Float-Assist to Boom function.
- Single Button control engages Dual Float system and Boom Float-Assist, resulting in cutter head following contour of ground.
- Float-Assist to Boom Function provides regulated lift pressure to Boom Function as well as Float Function, resulting in less ground pressure on ground roller.
- Operator can engage or disengage system instantly by using button. Float can be disengaged by operating Deck Roll In/Out or Boom Up functions.
- Increases bearing life with less operator fatigue.
- Provides accurate control over boom and head float.
- System is ideal for ditch mowing where speed and efficiency are essential.



**EFS - Electronic Joystick**



**Cable Controls**

## Cable Controls

- Cable Controls also available

### WildKat

A - Reach Out @Max.  
 B - Ground Level to Blade Tip  
 C - Reach Out @ Max. Down  
 D - Reach Down  
 E - Reach Out @ Max. Up  
 F - Reach Up  
 G - Reach In

### 60" Rotary

15'.5"  
 4.0'  
 9.5'  
 4.2'  
 9.7'  
 12.4'  
 6.2'

### 75" FLAIL

16.2'  
 4.1'  
 9.6'  
 5.0'  
 8.1'  
 13.1'  
 6.2'

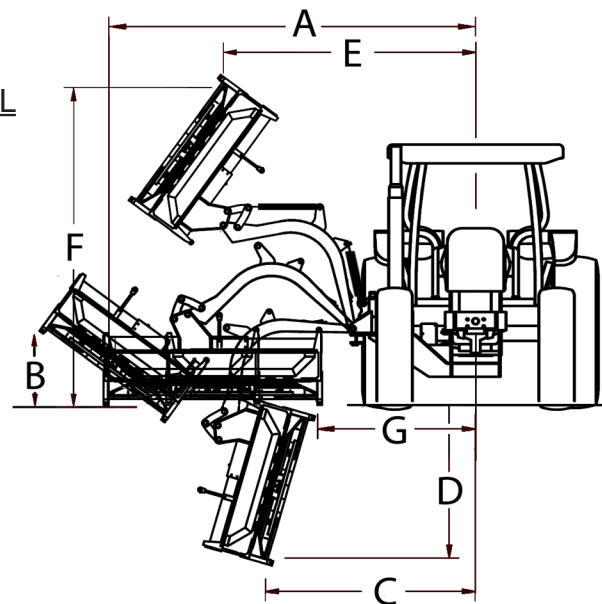

(All dimensions in feet with cutter head)

\*Specifications are subject to change based on make, model and tire size.  
 Optional equipment may be shown.\*

Tiger Corporation  
 3301 North Louise Ave  
 Sioux Falls, South Dakota 57107  
 800.843.6849  
[www.tigermowers.com](http://www.tigermowers.com)  
 An Alamo Group Company  
 Stay Connected  

## Dealer Info:

© 2020 Tiger Corporation. All Rights Reserved. Printed in the USA.



MADE WITH PRIDE IN THE USA